

River West Festival Park 25K
Tulsa, OK

Effective
01-04-16 to 12-31-26

USATF Certification
OK16001KH



GPS coordinates are given ONLY to get close to documented locations.

| | |
|---------|----------------------|
| S/F | 36.135000 -95.99913 |
| 1K-24K | 36.128347 -95.993129 |
| 2K-23K | 36.119836 -95.990513 |
| 3K-22K | 36.110940 -95.990005 |
| 4K-21K | 36.102194 -95.990655 |
| 5K-20K | 36.095190 -95.993268 |
| 6K-19K | 36.087720 -95.993757 |
| 7K-18K | 36.079289 -95.990225 |
| 8K-17K | 36.070528 -95.987871 |
| 9K-16K | 36.065114 -95.99101 |
| 10K-15K | 36.061062 -95.989147 |
| 11K-14K | 36.060851 -95.978041 |
| 12K-13K | 36.053995 -95.975802 |
| TA | 36.050004 -95.973313 |

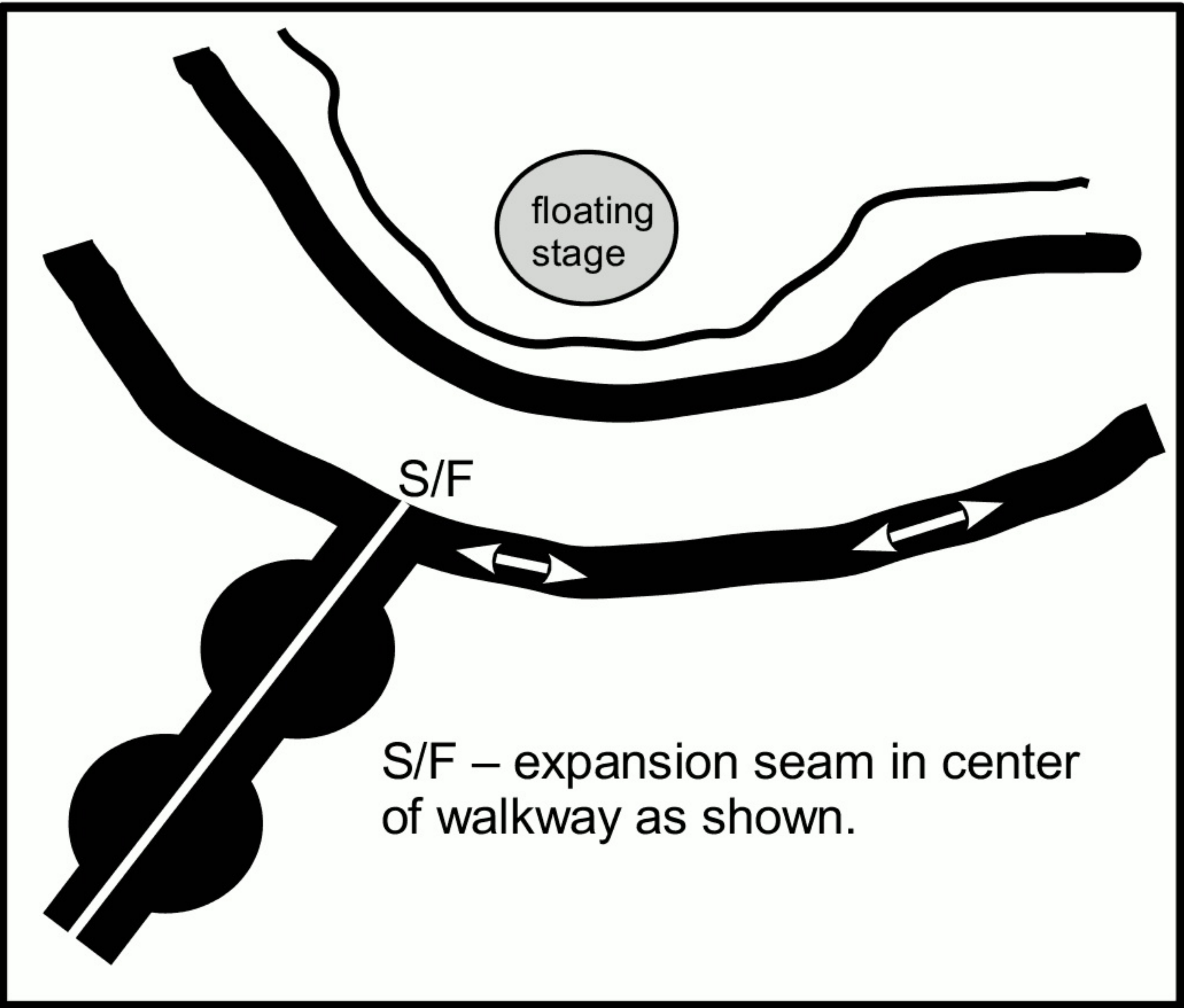

The map and diagrams reflect the km split number for the out portion. These are also km split location for splits as shown in this chart.

This course follows the Shortest Possible Route (SPR) over the whole pathway. In sections where Bike and Pedestrian lanes are split, use the Pedestrian lane except the bike lane is used leaving and approaching the Start/Finish.

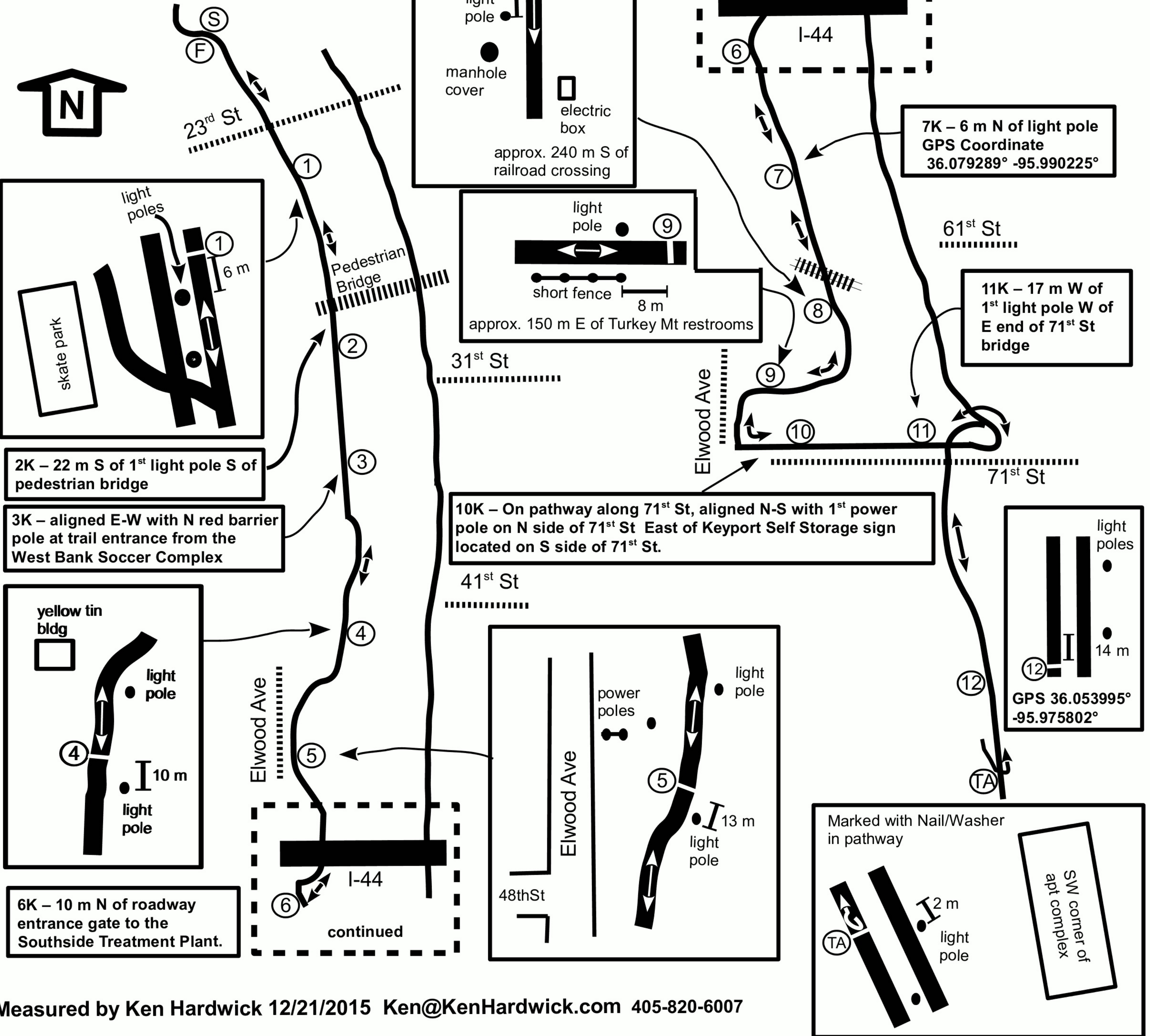



Road Running Technical Council
USA Track & Field
Measurement Certificate



Name of course: River West Festival Park 25K Distance: 25 km

Location : (state) Oklahoma (city) Tulsa

Type of course : road race ☒ calibration course ☐ track ☐

Measuring methods : bicycle ☒ steel tape ☐ electronic distance meter ☐

Measured by (name, address, phone & e-mail) Ken Hardwick 1509 Shrill Ct, Norman, OK 73071
405-820-6007 Ken@KenHardwick.com

Race Contact (name, address, phone & email) Tim Dreiling 418 East 2nd Street Tulsa, OK 74120
918-492-3338 tim@fleetfeettulsa.com

Date(s) when course measured: Dec. 21, 2015 Number of measurements of entire course: 2

Course Configuration: same out/ back 1 time

Elevation (meters above sea level) Start 197 m Finish 197 m Highest 233 m Lowest 184 m

Straight line distance between start & finish 0 m Drop 0 m/km Separation 0.0%

Type of Surface: Paved 100% Dirt 0% Gravel 0% Grass 0% Track 0%

Effective date of certification: Jan. 04, 2016 Certification code: OK16001KH

Notice to Race Director: Use this Certification code
in **all** public announcements relating to your race

Be It Officially Noted That

Based on examination of data provided by the above named measurer, the course described above and in the map attached is hereby certified as reasonably accurate in measurement according to the standards adopted by the Road Running Technical Council. If any changes are made to the course, this certification becomes void, and the course must then be recertified.

Verification of Course — In the event a National Open Record is set on this course, or at the discretion of USA Track & Field, a verification remeasurement may be required to be performed by a member of the Road Running Technical Council. If such a remeasurement shows the course to be short, then all pending records will be rejected and the course certification will be cancelled.

This certification expires on December 31 in the year

2026

AS NATIONALLY CERTIFIED BY

Ken Hardwick

Date : Jan. 4, 2016

Ken Hardwick - USATF, RRTC Certifier - 1509 Shrill Ct, Norman, Ok 73071
405-820-6007 Ken@KenHardwick.com

River West Festival Park 50K
Tulsa, OK

Effective
01-04-16 to 12-31-26

USATF Certification
OK16002KH



GPS coordinates are given ONLY to get close to documented locations.

| | | |
|-----------------|----|----------------------|
| S -25K | -F | 36.135000 -95.99913 |
| 1K-24K-26K-49K | | 36.128347 -95.993129 |
| 2K-23K-27K-48K | | 36.119836 -95.990513 |
| 3K-22K-28K-47K | | 36.110940 -95.990005 |
| 4K-21K-29K-46K | | 36.102194 -95.990655 |
| 5K-20K-30K-45K | | 36.095190 -95.993268 |
| 6K-19K-31K-44K | | 36.087720 -95.993757 |
| 7K-18K-32K-43K | | 36.079289 -95.990225 |
| 8K-17K-33K-42K | | 36.070528 -95.987871 |
| 9K-16K-34K-41K | | 36.065114 -95.991010 |
| 10K-15K-35K-40K | | 36.061062 -95.989147 |
| 11K-14K-36K-39K | | 36.060851 -95.978041 |
| 12K-13K-37K-38K | | 36.053995 -95.975802 |
| TA | | 36.050004 -95.973313 |
| Marathon | | 36.072192 -95.988570 |

The map and diagrams reflect the km split number for the 1st out portion. These are also km split location for splits as shown in this chart.

This course follows the Shortest Possible Route (SPR) over the whole pathway. In sections where Bike and Pedestrian lanes are split, use the Pedestrian lane except the bike lane is used leaving and approaching the Start/25K/Finish.

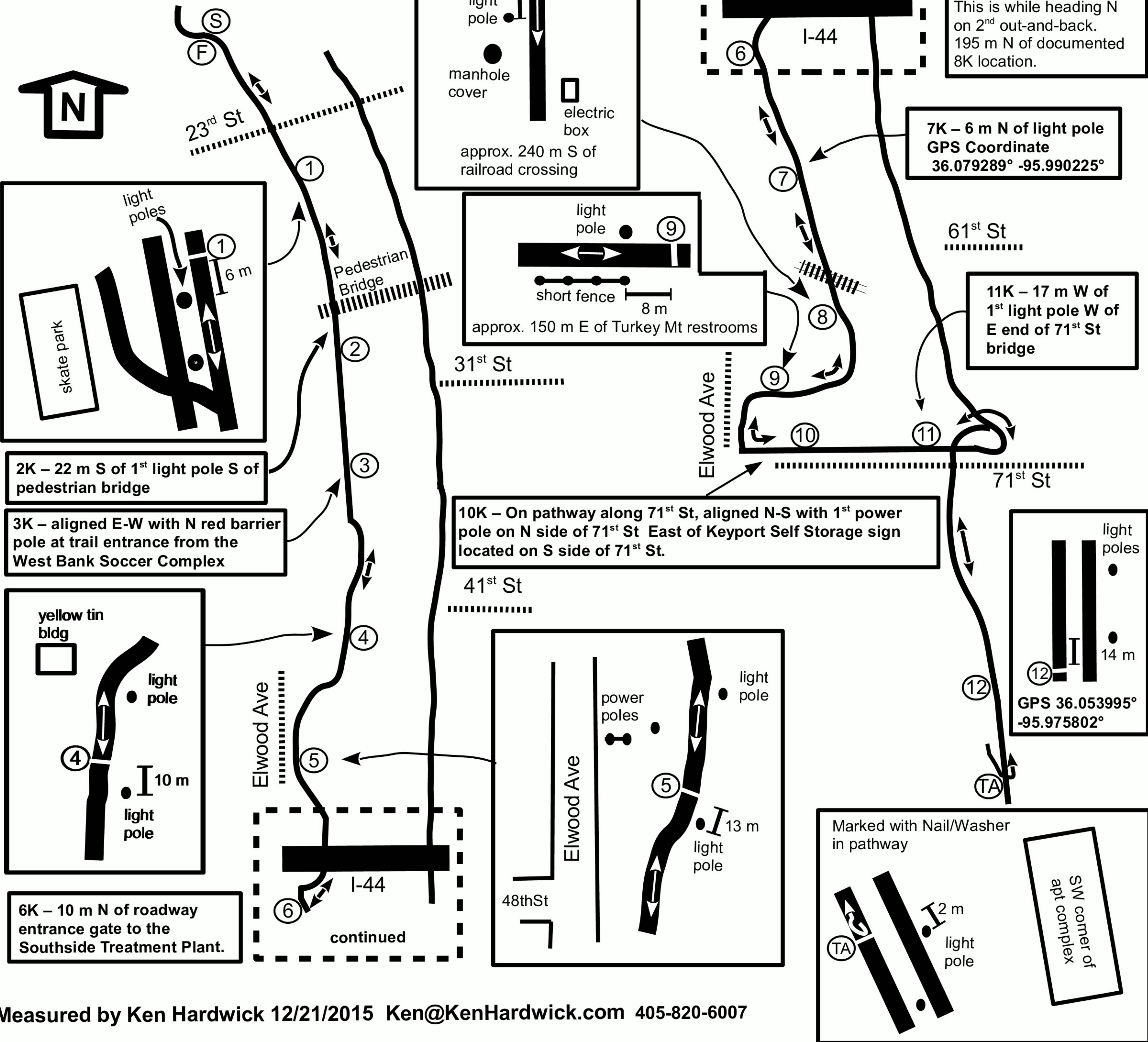
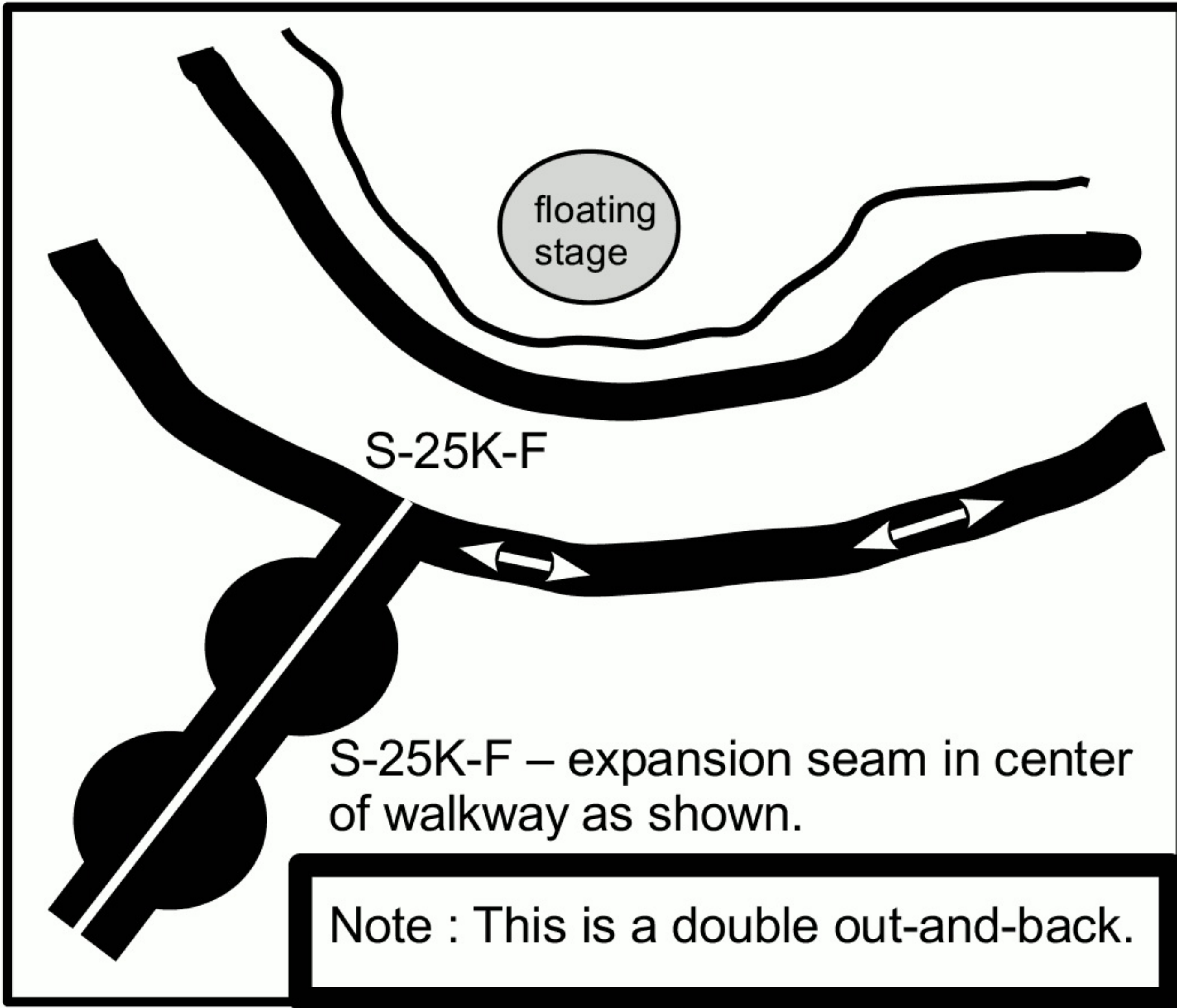



Road Running Technical Council
USA Track & Field
Measurement Certificate



Name of course: River West Festival Park 50K Distance: 50 km

Location : (state) Oklahoma (city) Tulsa

Type of course : road race ☒ calibration course ☐ track ☐

Measuring methods : bicycle ☒ steel tape ☐ electronic distance meter ☐

Measured by (name, address, phone & e-mail) Ken Hardwick 1509 Shril Ct, Norman, OK 73071
405-820-6007 Ken@KenHardwick.com

Race Contact (name, address, phone & email) Tim Dreiling 418 East 2nd Street Tulsa, OK 74120
918-492-3338 tim@fleetfeettulsa.com

Date(s) when course measured: Dec. 21, 2015 Number of measurements of entire course: 2

Course Configuration: same out/ back 2 times

Elevation (meters above sea level) Start 197 m Finish 197 m Highest 233 m Lowest 184 m

Straight line distance between start & finish 0 m Drop 0 m/km Separation 0.0%

Type of Surface: Paved 100% Dirt 0% Gravel 0% Grass 0% Track 0%

Effective date of certification: Jan. 04, 2016 Certification code: OK16002KH

Notice to Race Director: Use this Certification code
in **all** public announcements relating to your race

Be It Officially Noted That

Based on examination of data provided by the above named measurer, the course described above and in the map attached is hereby certified as reasonably accurate in measurement according to the standards adopted by the Road Running Technical Council. If any changes are made to the course, this certification becomes void, and the course must then be recertified.

Verification of Course — In the event a National Open Record is set on this course, or at the discretion of USA Track & Field, a verification remeasurement may be required to be performed by a member of the Road Running Technical Council. If such a remeasurement shows the course to be short, then all pending records will be rejected and the course certification will be cancelled.

This certification expires on December 31 in the year

2026

AS NATIONALLY CERTIFIED BY

Ken Hardwick

Date : Jan. 4, 2016

Ken Hardwick - USATF, RRTC Certifier - 1509 Shril Ct, Norman, Ok 73071
405-820-6007 Ken@KenHardwick.com